

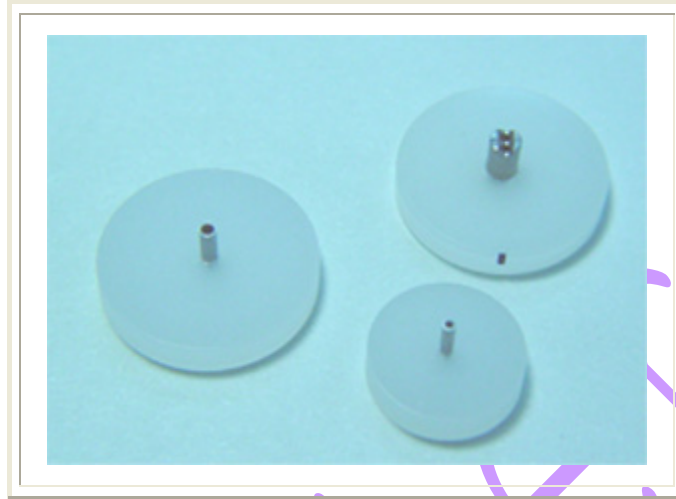

FUJI CP3 SMT NOZZLE



Part Number (OEM)	Description
AGPH - 9560	FUJI CP3/S SMT NOZZLE Ø 0.7
AGPH - 9410	FUJI CP3/S SMT NOZZLE Ø 1.0
AGPH - 9130	FUJI CP3/S SMT NOZZLE Ø 1.3
AGPH - 9050	FUJI CP3/S SMT NOZZLE Ø 1.3 (MELF)
AGPH - 9470	FUJI CP3/L SMT NOZZLE Ø 1.3
AGPH - 9060	FUJI CP3/L SMT NOZZLE Ø 2.5
AGPH - 9430	CP3/L Ø 3.4
AGPH - 9460	CP3/L Ø 1.3 (MELF)



**FUJI CP3 DARKPOINT SMT NOZZLE**

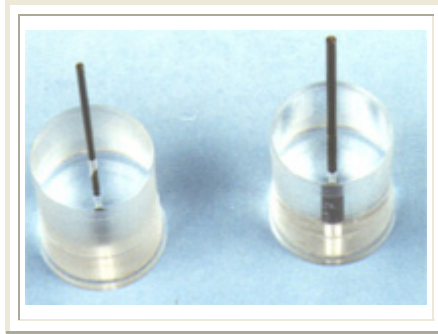

Part Number (OEM)	Description
AGPH - 9570	CP3/DPT-S DARK POINT Ø 0.7/ Ø 11.5
AGPH - 9550	CP3/DPT-S DARK POINT Ø 1.0/ Ø 11.5
AGPH - 9190	CP3/DPT-S DARK POINT Ø 1.3/ Ø 11.5
AGPH - 9200	CP3/DPT-S DARK POINT Ø 2.5/ Ø 16.5
AGPH - 9440	CP3/DPT-S DARK POINT Ø 3.4/ Ø 16.5



FUJI CP4 SMT NOZZLE



Part Number (OEM)	Description
AMPH - 8710	CP4/S Ø 0.7
AMPH - 8720	CP4/S Ø 1.0
AMPH - 8730	CP4/S Ø 1.3
AMPH - 8740	CP4/S Ø 1.8
AMPH - 8750	CP4/S Ø 2.5
AMPH - 8760	CP4/L Ø 2.5
AMPH - 8770	CP4/L Ø 3.7
AMPH - 8780	CP4/L Ø 5.0



FUJI CP6 SMT NOZZLE



Part Number (OEM)	Description
AWPH - 9510	CP6/S Ø 0.7
AWPH - 9520	CP6/S Ø 1.0
AWPH - 9530	CP6/S Ø 1.3
AWPH - 9550	CP6/S Ø 1.8
AWPH - 9541	CP6/S Ø 1.3 (MELF)
AWPH - 9580	CP6/L Ø 2.5
AWPH - 9600	CP6/L Ø 3.7
AWPH - 9591	CP6/L Ø 2.5 (MELF)
AWPH - 9560	CP6/M Ø 2.5



FUJI CP7 SMT NOZZLE



Part Number (OEM)	Description
ADCPH - 9510	CP7/S Ø0.4 (8mm Diameter)
ADCPH - 9520	CP7/S Ø0.7 (8mm Diameter)
ADCPH - 9530	CP7/S Ø1.0 (8mm Diameter)
ADCPH - 9540	CP7/S Ø1.3 (8mm Diameter)
ADCPH - 9700	CP7/S Ø1.3 (8mm Diameter) MELF
ADCPH - 9550	CP7/S Ø1.8 (16mm Diameter)
ADCPH - 9560	CP7/L Ø2.5 (16mm Diameter)
ADCPH - 9710	CP7/L Ø2.5 (16mm Diameter) MELF
ADCPH - 9570	CP7/L Ø3.7 (16mm Diameter)
ADCPH - 9580	CP7/L Ø5.0 (16mm Diameter) SQUARE



FUJI IP SMT NOZZLE



Part Number (OEM)	Description
	FUJI IP SMT NOZZLE - SS NOZZLE Ø 1.0
IPH - 3431	FUJI IP SMT NOZZLE - S NOZZLE Ø 1.3
IPH - 3421	FUJI IP SMT NOZZLE - M NOZZLE Ø 2.5
IPH - 3411	FUJI IP SMT NOZZLE - L NOZZLE Ø 4.0
IPH - 3401	FUJI IP SMT NOZZLE - LL NOZZLE Ø 7.0 (WITH CAP)
IPH - 4511	IP - LL NOZZLE Ø 10.0 (WITH CAP)
IPH - 4520	IP - LL NOZZLE Ø 15.0 (WITH CAP)
IPH - 4531	IP - LL NOZZLE Ø 20.0 (WITH CAP)
IPH - 4541	



FUJI IP2 SMT NOZZLE

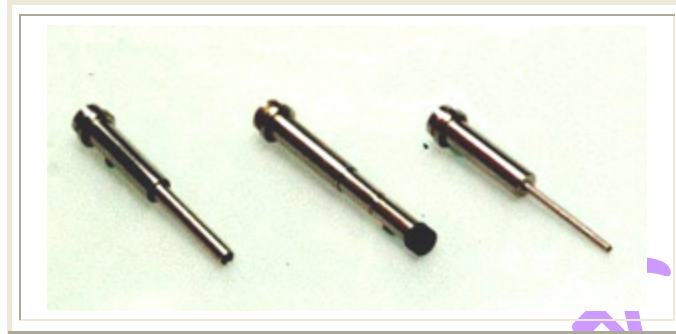

Part Number (OEM)	Description
AKPH - 2051	IP2 - SS Ø 1.0 (FIXED)
AKPH - 2031	IP2 - S Ø 1.3 (FIXED)
AKPH - 2041	IP2 - M Ø 2.5 (FIXED)
AKPH - 2061	IP2 - L Ø 4.0 (FIXED)



FUJI IP3 SMT NOZZLE

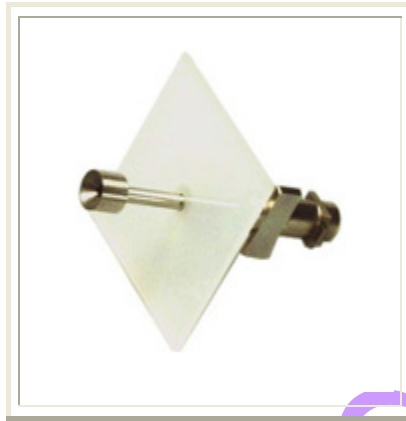

Part Number (OEM)	Description
AQNA - 3130/39	IP3 - Ø 1.3 (FIXED) (31 x 31mm)
AQNA - 3140/49	IP3 - Ø 1.8 (FIXED) (31 x 31mm)
AQNA - 3150/59	IP3 - Ø 2.5 (FIXED) (31 x 31mm)
AQNA - 3160/69	IP3 - Ø 3.7 (FIXED) (31 x 31mm)
AQNA - 3170	IP3 - Ø 7.0 (FIXED) (31 x 31mm)
AQNA - 3180	IP3 - Ø 10.0 (FIXED) (52 x 52mm)
AQNA - 3190	IP3 - Ø 15.0 (FIXED) (62 x 62mm)
AQNA - 3200/01	IP3 - Ø 20.0 (FIXED) (102 x 102mm)
AQNA - 3290/95	IP3 - Ø 3.7 (FIXED) (52 x 52mm)
AQNA - 3300/04	IP3 - Ø 7.0 (FIXED) (52 x 52mm)
AQNA - 3310/14	IP3 - Ø 10.0 (FIXED) (62 x 62mm)
AQNA - 3320/24	IP3 - Ø 15.0 (FIXED) (102 x 102mm)
AQNA - 3330/34	IP3 - Ø 6.5 (FIXED) (52 x 52mm)





**FUJI IP/IP2 ADAPTOR**



Part Number (OEM)	Description
IPA - 0007	IP - LL ADAPTOR Ø 7.0
IPA - 0010	IP - LL ADAPTOR Ø 10.0
IPA - 0015	IP - LL ADAPTOR Ø 15.0
IPA - 0020	IP - LL ADAPTOR Ø 20.0



FUJI QP SMT NOZZLE



Part Number (OEM)	Description
BHPN - 3271	QP SMT NOZZLE SPRING PLATE
BHPN - 3232	QP SMT NOZZLE SPRING PLATE
ABHPN - 6246	- Ø 2.5
ABHPN - 6256	- Ø 3.75
ABHPN - 6276	- Ø 7.0
ABHPN - 6365	- Ø 7.0
ABHPN - 6852	- Ø 5.0 (W/RUBBER CUP)
ABHPN - 6893	- Ø 8.0 (W/RUBBER CUP)
ABHPN - 6803	- Ø 15.0 (W/RUBBER CUP)
ABHPN - 6703	- Ø 17.5 (W/RUBBER CUP)



FUJI QP132 INDEX SMT NOZZLE

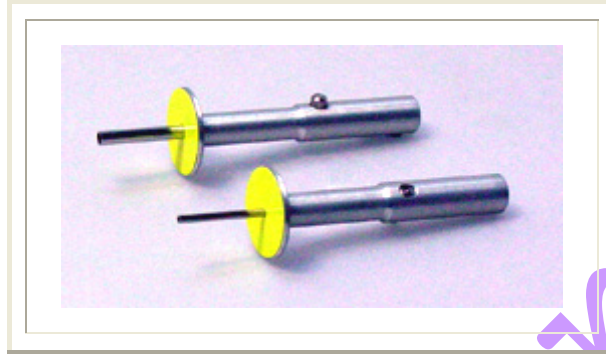

Part Number	Description
CGPN-8036	QP132 $\emptyset 0.7 / \emptyset 0.4$
CGPN-80250	QP132 $\emptyset 1.0 / \emptyset 0.7$
CGPN-8015	QP132 $\emptyset 1.3 / \emptyset 0.9$



FUJI QP242 INDEX SMT NOZZLE

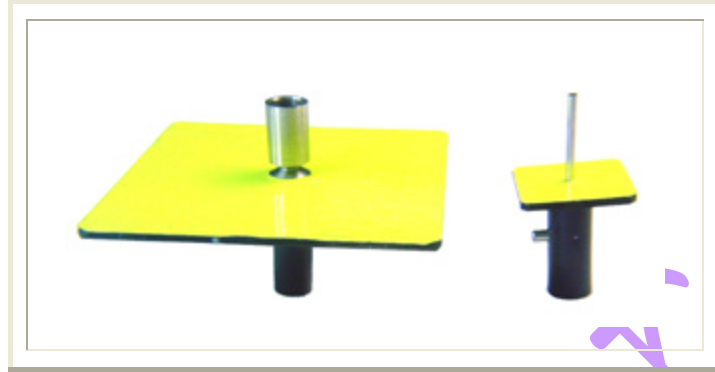

Part Number (OEM)	Description
ABHPN - 8510	QP-S-12 -Ø 0.7
ABHPN - 8520	QP-S-12 NZ. Ø 1.0
ABHPN - 8530	QP-S-12 NZ. Ø 1.3 / 1.0
ABHDN - 8560	QP-M-38 NZ. Ø 2.5 / 1.9
ABHDN - 8570	QP-M-38 NZ. Ø 3.7 / 1.7
ABHPN - 8590	QP-L-47 NZ. Ø 7.0

**FUJI QP341 INDEX SMT NOZZLE**



Part Number (OEM)	Description
ADBPN-8123	QP-3 NOZZLE 1.8Φ
ADBPN-8133	QP-3 NOZZLE 2.5Φ
ADBPN-8193	QP-3 NOZZLE 2.5ΦG
ADBPN-8143	QP-3 NOZZLE 3.75Φ
ADBPN-8023	QP-3 NOZZLE 5Φ
ADBPN-8203	QP-3 NOZZLE 5ΦG
ADBPN-8213	QP-3 NOZZLE 8ΦG
ADBPN-8223	QP-3 NOZZLE 15ΦG
ADBPN-8233	QP-3 NOZZLE 17.5ΦG
ADBPN-8180	QP-3 NOZZLE SINGLE 20Φ L=270
ADBPN-8440	QP-3 NOZZLE SINGLE 20Φ L=200
ADBPN-8340	QP-3 NOZZLE SINGLE 20Φ L=110
ADBPN-8341	QP-3 NOZZLE SINGLE 23ΦG (for BGA)



FUJI XP 141 SMT NOZZLE



Part Number (OEM)	Description
ADEPN-8070	XP-141 NOZZLE ASS'Y-0.7Φ
ADEPN-8080	XP-141 NOZZLE ASS'Y-1.0Φ
ADEPN-8090	XP-141 NOZZLE ASS'Y-1.3Φ
ADEPN-8100	XP-141 NOZZLE ASS'Y-1.8Φ



FUJI XP 142 143 SMT NOZZLE



Part Number	Description
ADNPN8210	XP-142 NOZZLE ASS'Y-0.7Φ
ADNPN8230	XP-142 NOZZLE ASS'Y-1.0Φ
ADNPN8240	XP-142 NOZZLE ASS'Y-1.3Φ
ADNPN8210	XP-142 NOZZLE ASS'Y-0.7Φ
ADNPN8230	XP-142 NOZZLE ASS'Y-1.0Φ
ADNPN8240	XP-142 NOZZLE ASS'Y-1.3Φ
ADNPN8250	XP-142 NOZZLE ASS'Y-1.8Φ
ADNPN8260	XP-142 NOZZLE ASS'Y-2.5Φ
ADNPN8270	XP-142 NOZZLE ASS'Y-3.7Φ
ADNPN8280	XP-142 NOZZLE ASS'Y-5.0Φ



FUJI XP 241 341 SMT NOZZLE

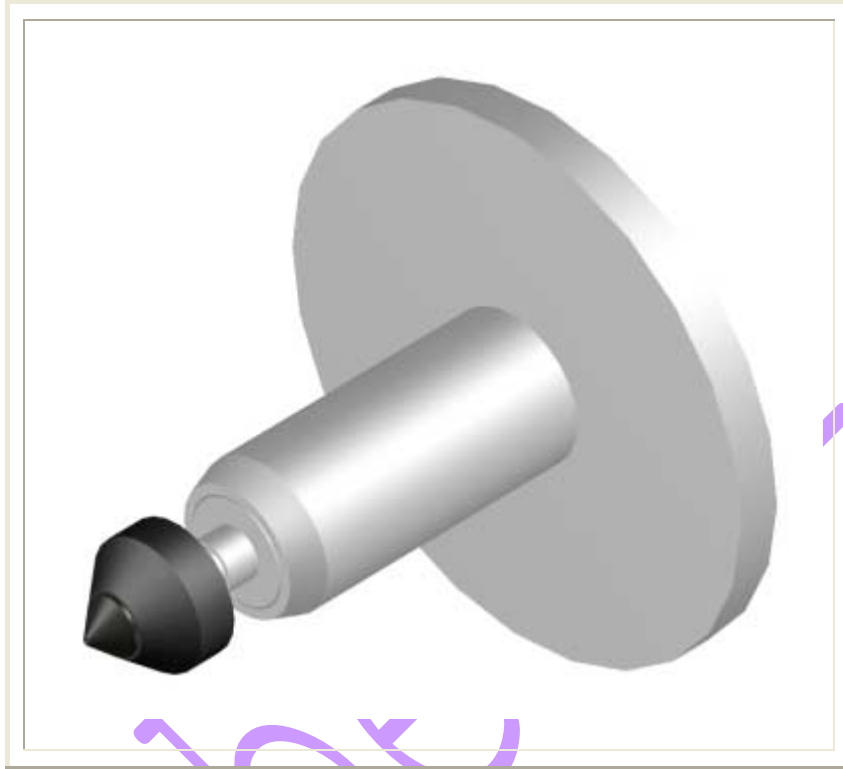

Part Number (OEM)	Description
ADEPN8510	FUJI XP2 PICK UP NOZZLE $\phi$ 0.7
ADEPN8520	FUJI XP2 PICK UP NOZZLE $\phi$ 1.0
ADEPN8530	FUJI XP2 PICK UP NOZZLE $\phi$ 1.3
ADEPN8540	FUJI XP2 PICK UP NOZZLE $\phi$ 1.8
ADEPN8550	FUJI XP2 PICK UP NOZZLE $\phi$ 2.5
ADEPN8560	FUJI XP2 PICK UP NOZZLE $\phi$ 3.7
ADEPN8530	FUJI XP3 PICK UP NOZZLE $\phi$ 0.7
ADEPN8540	FUJI XP3 PICK UP NOZZLE $\phi$ 1.0



ADEPN8550	FUJI XP3 PICK UP NOZZLE $\phi$ 1.3
ADEPN8560	FUJI XP3 PICK UP NOZZLE $\phi$ 1.8
DEPN3080	FUJI XP3 PICK UP NOZZLE $\phi$ 5.0
DEPN3089	FUJI XP3 PICK UP NOZZLE $\phi$ 7.0
DEPN3100	FUJI XP3 PICK UP NOZZLE $\phi$ 10
DEPN3110	FUJI XP3 PICK UP NOZZLE $\phi$ 15
DEPN3120	FUJI XP3 PICK UP NOZZLE $\phi$ 20

**FUJI GL II & V DISPENDING NOZZLE**



Part Number (OEM)	Description
ANRG - 2012	FUJI GL II & V DISPENDING NOZZLE. 1D/1S $\phi$ 0.6/ $\phi$ 0.3
ANRG - 2021	FUJI GL II & V DISPENDING NOZZLE. 1D/1S $\phi$ 0.7/ $\phi$ 0.4
AHRG - 0696	FUJI GL II & V DISPENDING NOZZLE. 1D/1S $\phi$ 0.8/ $\phi$ 0.5
AHRG - 0700	FUJI GL II & V DISPENDING NOZZLE. 1D/1S $\phi$ 0.9/ $\phi$ 0.6
AHRG - 1330	1D/1S $\phi$ 0.9/ $\phi$ 0.6
AHRG - 1350	1D/1S $\phi$ 1.0/ $\phi$ 0.7
AJRG - 0830	2D/1S $\phi$ 0.6/ $\phi$ 0.3 P = 0.8
AHRG - 0679<	2D/1S $\phi$ 0.7/ $\phi$ 0.4 P = 1.3
AHRG - 0857	2D/2S $\phi$ 0.7/ $\phi$ 0.4 P = 1.0
AHRG - 1320	2D/2S $\phi$ 0.8/ $\phi$ 0.5 P = 1.0



FUJI NXT NOZZLE



Part Number (OEM)	Description
	H01 PLACING HEAD
AA0AS00	Nozzle 1.0
AA06800	Nozzle 1.3
AA0HL00	Nozzle 1.8
AA0HM00	Nozzle 2.5
AA0HN00	Nozzle 3.7
AA0HR01	Nozzle 5.0
AA08000	Nozzle 7.0
AA08100	Nozzle 10.0
AA08200	Nozzle 15.0
AA08300	Nozzle 20.0
AA0MZ00	Nozzle 1.3m MELF



AA11R00	Nozzle 1.8m MELF
AA08410	Nozzle 2.5G with rubber pad
AA08500	Nozzle 3.7G with rubber pad
AA07200	Nozzle 5.0G with rubber pad
AA07310	Nozzle 7.0G with rubber pad
AA07410	Nozzle 10.0G with rubber pad
AA07510	Nozzle 15.0G with rubber pad
AA07610	Nozzle 20.0G with rubber pad
	H04 PLACING HEAD
AA06W00	Nozzle 1.0
AA06X00	Nozzle 1.3
AA06Y00	Nozzle 1.8
AA06Z00	Nozzle 2.5
AA07A00	Nozzle 3.7
AA07B00	Nozzle 5.0
AA07C00	Nozzle 7.0
AA07D00	Nozzle 10.0
AA07E00	Nozzle 15.0
AA22Y00	Nozzle 1.3m MELF
AA22Z00	Nozzle 1.8m MELF
AA07F00	Nozzle 2.5 with rubber pad
AA00G00	Nozzle 3.7 with rubber pad
AA00H00	Nozzle 5.0 with rubber pad
AA07K00	Nozzle 7.0 with rubber pad



AA07L00	Nozzle 10.0 with rubber pad
AA07M00	Nozzle 15.0 with rubber pad
	小 08/ H12S PLACING HEAD
AA1AT00	Nozzle 0.3
AA05600	Nozzle 0.4
AA05700	Nozzle 0.7
AA05800	Nozzle 1.0
AA20A00	Nozzle 1.3
AA20B00	Nozzle 1.8
AA20C01	Nozzle 2.5
AA0WT00	Nozzle 2.5G
AA20D00	Nozzle 3.7
AA20E00	Nozzle 5.0
AA06400	Nozzle 1.3m MELF
AA19G00	Nozzle 1.8m MELF
AA18C00	Nozzle 3.7G with rubber pad
AA06300	Nozzle 5.0G with rubber pad